



DESIGN GUIDE

BUILT-IN SERIES STAINLESS FLUSH INSET INSTALLATION



EFFECTIVE 1/9/2017

Features and specifications are subject to change at any time without notice. Visit subzerowolf.com.au for the most up-to-date information.

BUILT-IN REFRIGERATION

Built-In Refrigeration

Sub-Zero designers and engineers continue to perfect the built-in line. The addition of LED lighting throughout and several new models with internal water dispensers, along with the same advanced food preservation technology Sub-Zero is known for, make the built-in line nothing short of revolutionary.

BUILT-IN MODELS

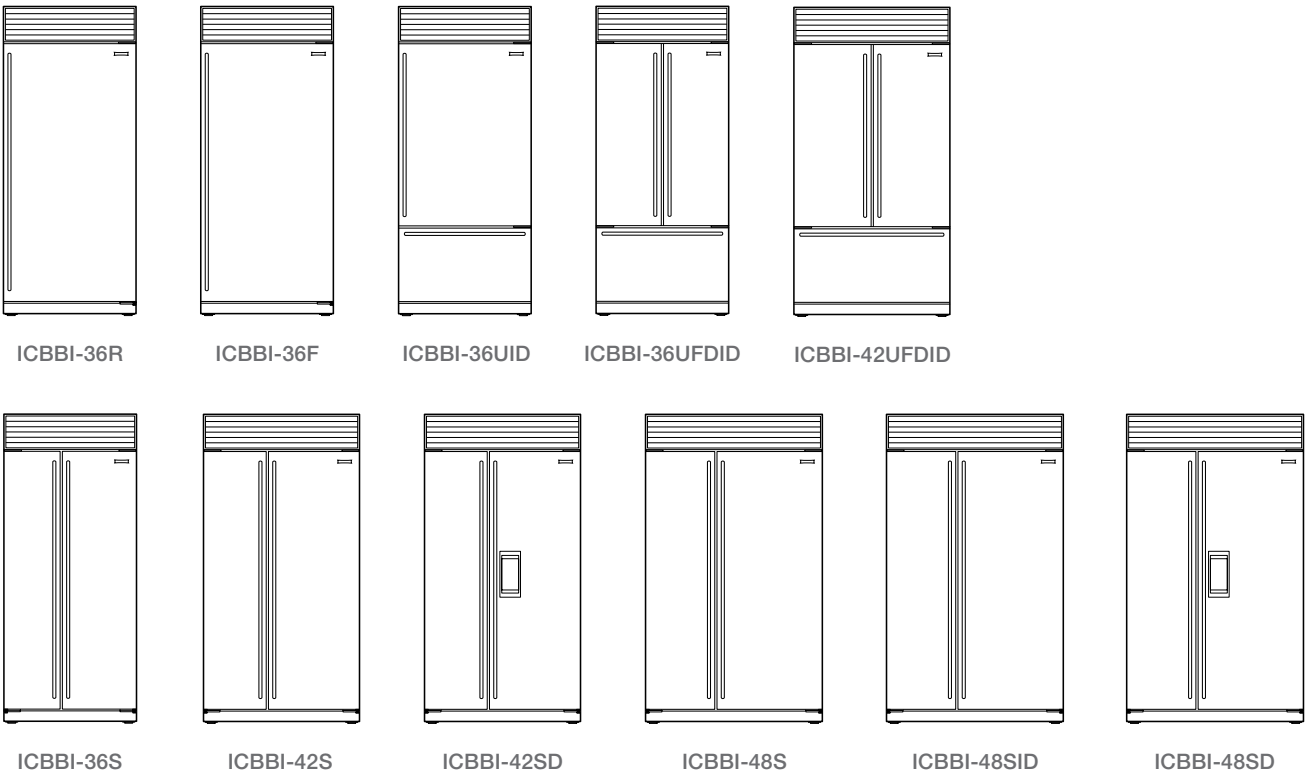

Built-In Models

SPECIFICATIONS

Interior Capacity	R (L)	F (L)
ALL REFRIGERATOR / ALL FREEZER MODELS		
ICBBI-36R	662	
ICBBI-36F		640
OVER-AND-UNDER MODELS		
ICBBI-30U	362	116
ICBBI-36U	451	149
SIDE-BY-SIDE MODELS		
ICBBI-36S	346	227
ICBBI-42S	455	227
ICBBI-42SD	453	230
ICBBI-48S	533	270
ICBBI-48SD	531	274

Shipping Weight	kg
ALL REFRIGERATOR / ALL FREEZER MODELS	
ICBBI-36R	191
ICBBI-36F	184
OVER-AND-UNDER MODELS	
ICBBI-30U	210
ICBBI-36U	234
SIDE-BY-SIDE MODELS	
ICBBI-36S	244
ICBBI-42S	264
ICBBI-42SD	276
ICBBI-48S	286
ICBBI-48SD	298

All Refrigerator / All Freezer Models

OVERALL DIMENSIONS

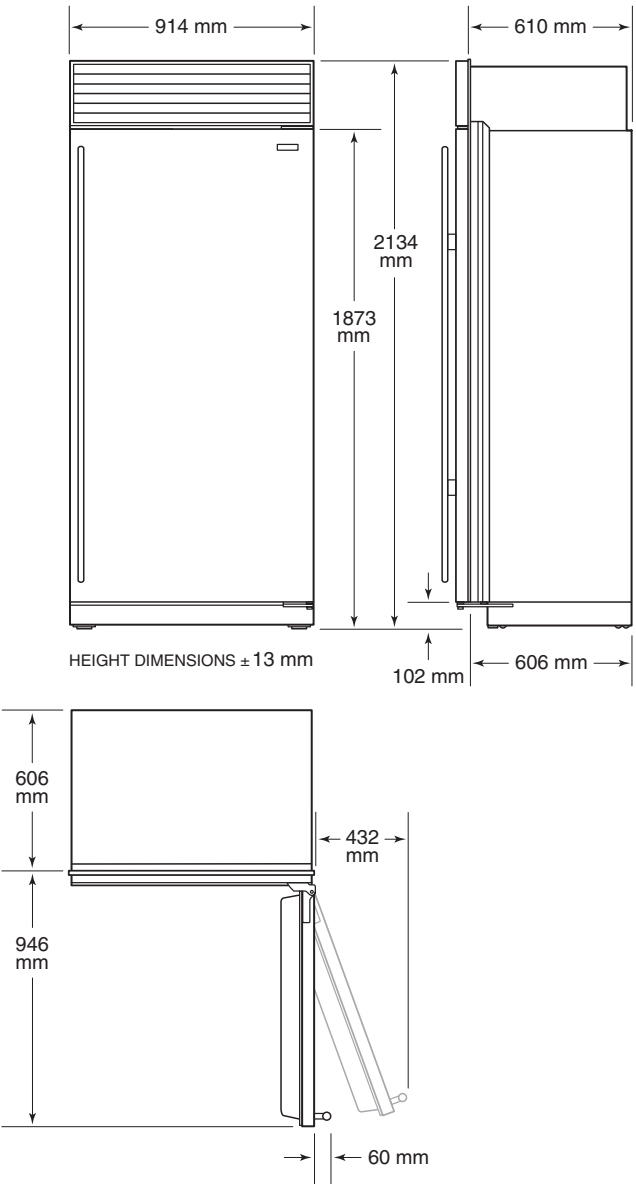

MODELS ICBBI-36R AND ICBBI-36F

Shipping weights and overall dimensions are based on stainless steel models. For flush inset applications, add 13 mm to door clearance dimensions.

Over-and-Under Models

OVERALL DIMENSIONS

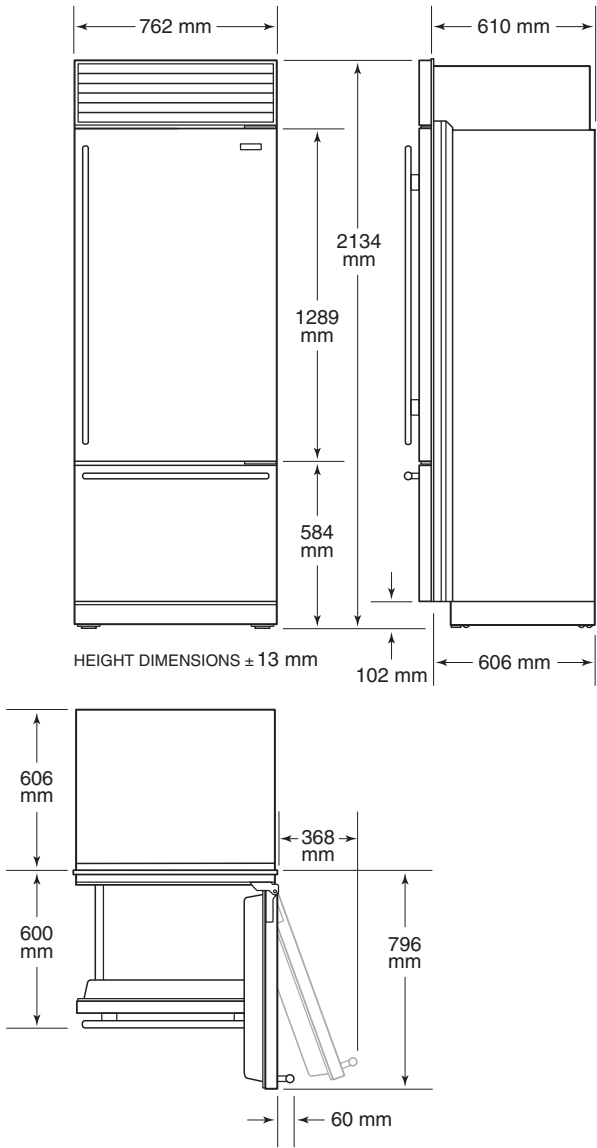

MODEL ICBBI-30U

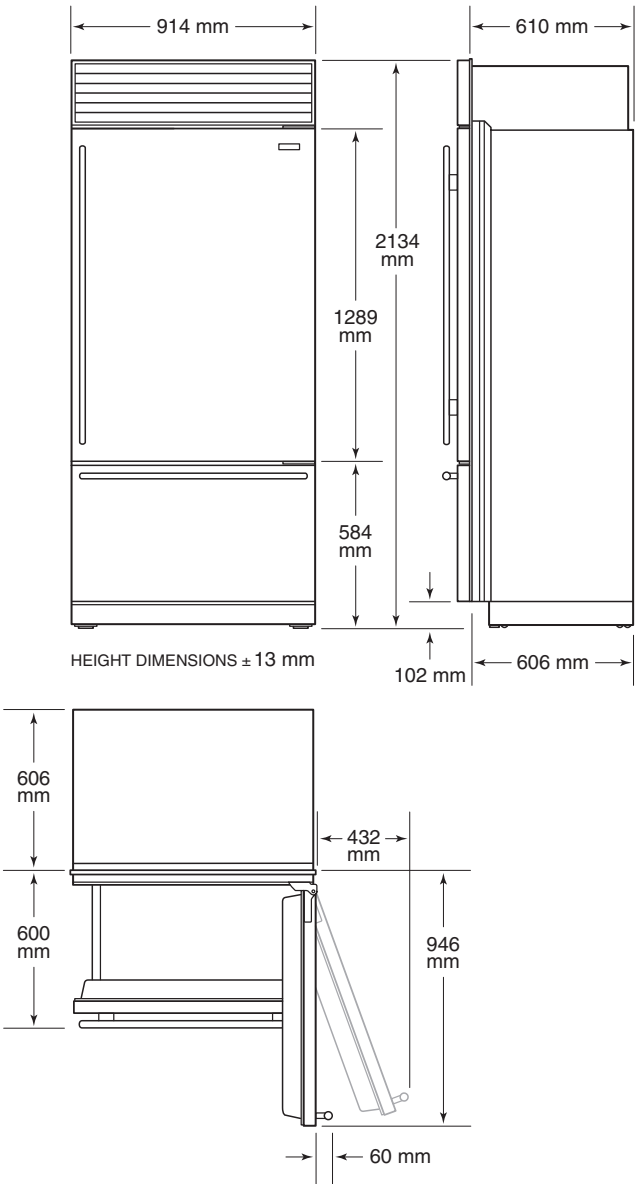

MODEL ICBBI-36UID

Overall Dimensions

OVER-AND-UNDER

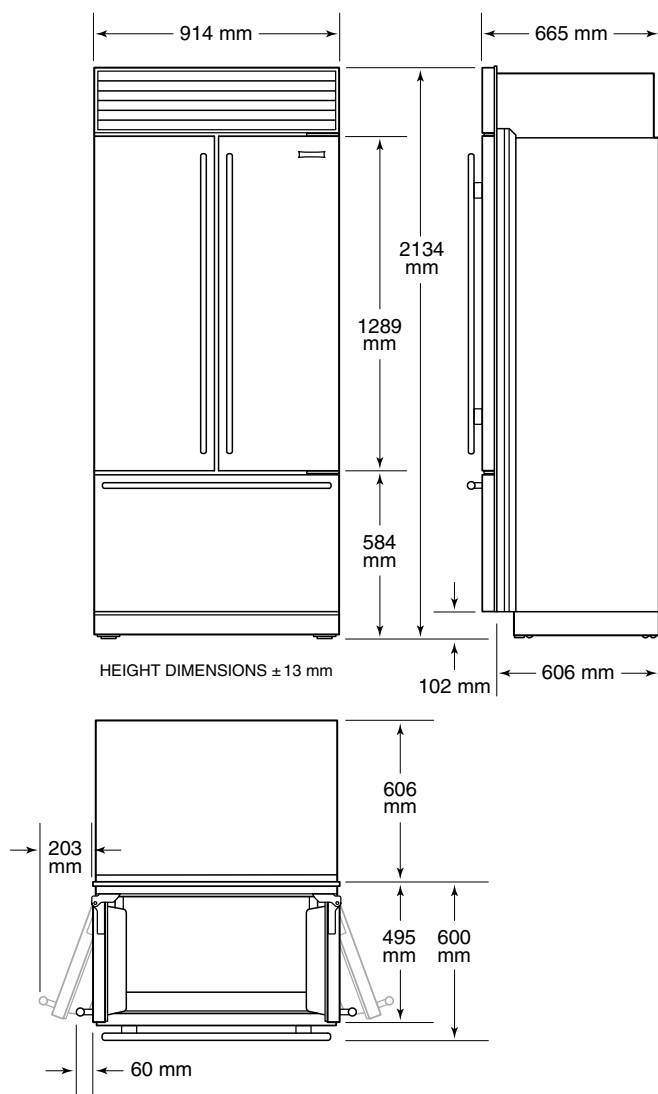

Model ICBBI-36UFDID.

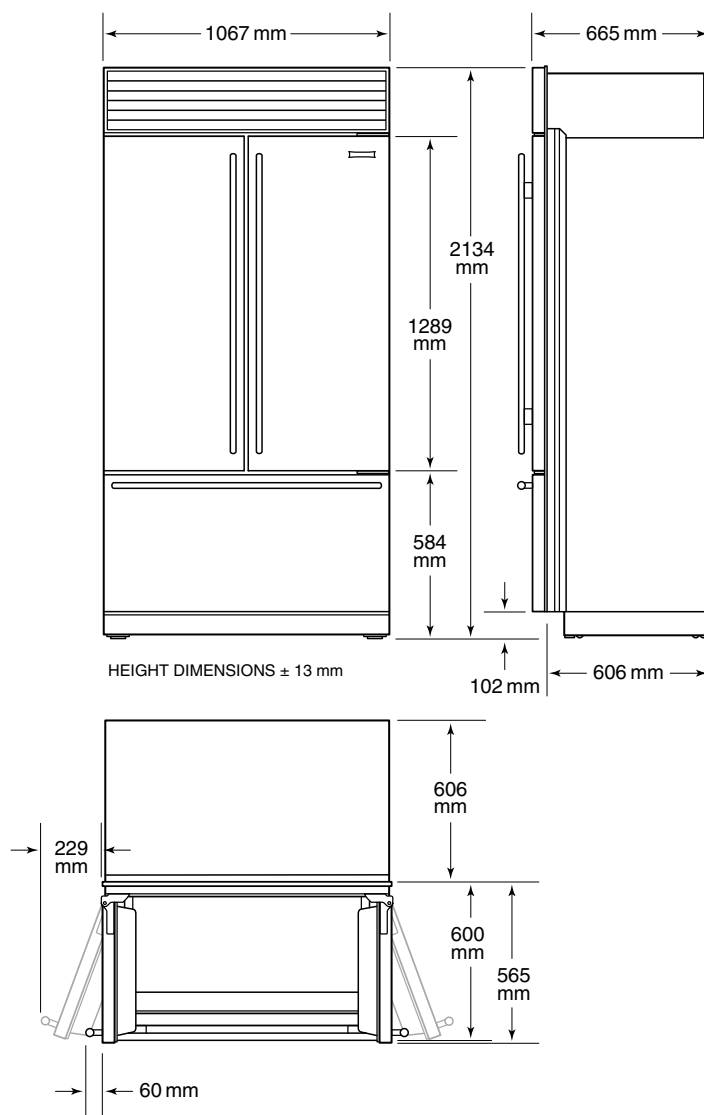

Model ICBBI-42UFDID.

Side-by-Side Models

OVERALL DIMENSIONS

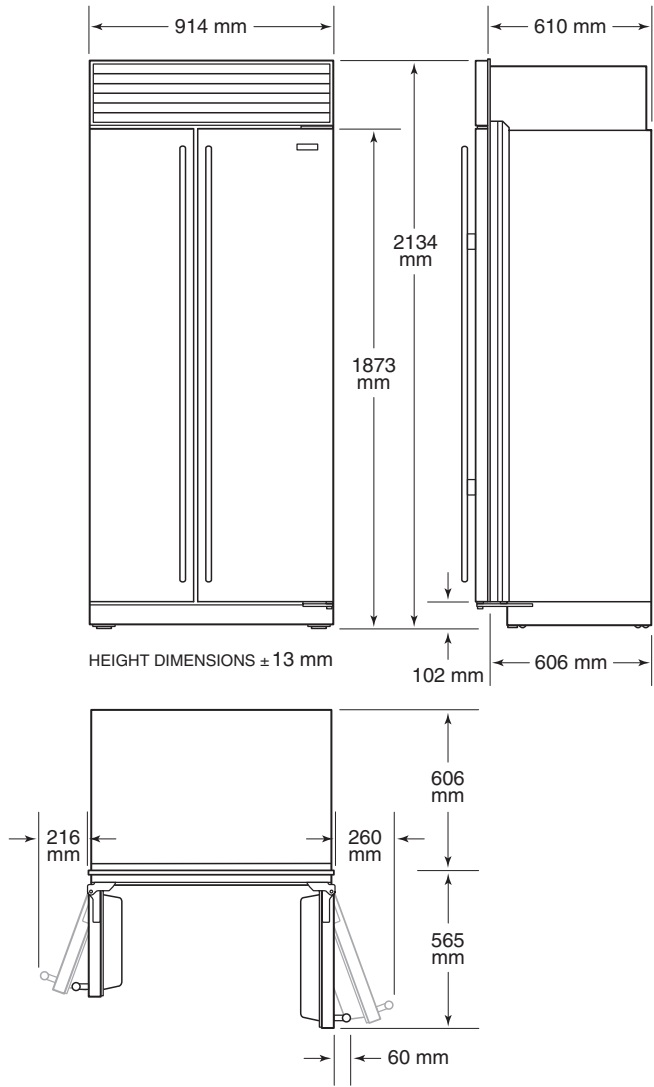

MODEL ICBBI-36S

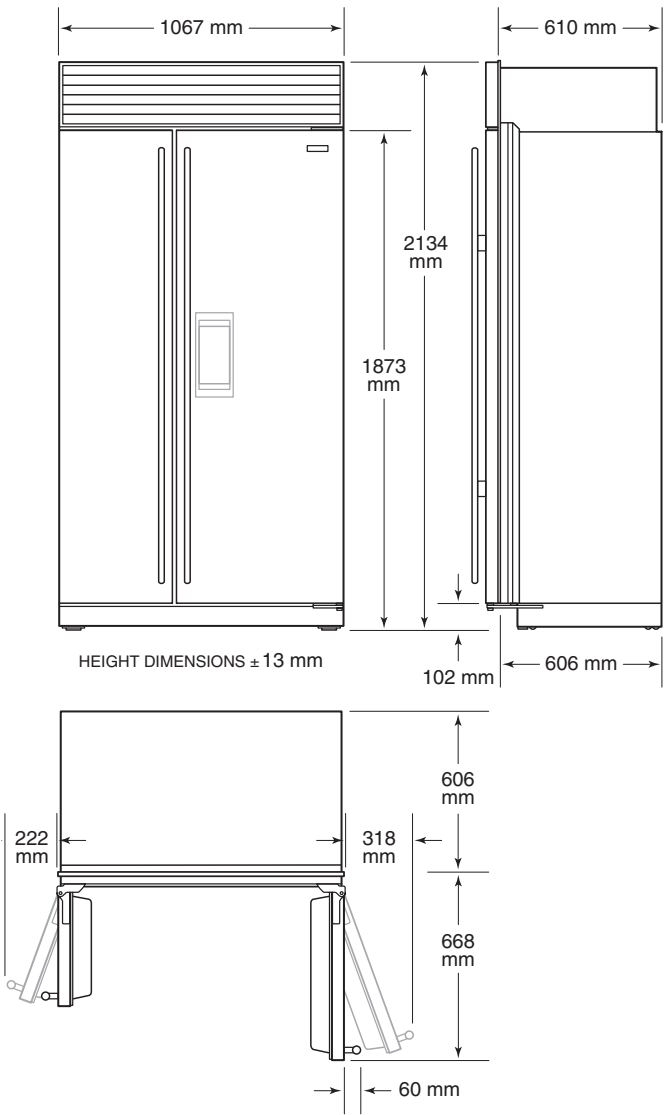

MODELS ICBBI-42S AND ICBBI-42SD

Overall dimensions are based on stainless steel models.
For flush inset applications, add 13 mm to door clearance dimensions.

Side-by-Side Models

OVERALL DIMENSIONS

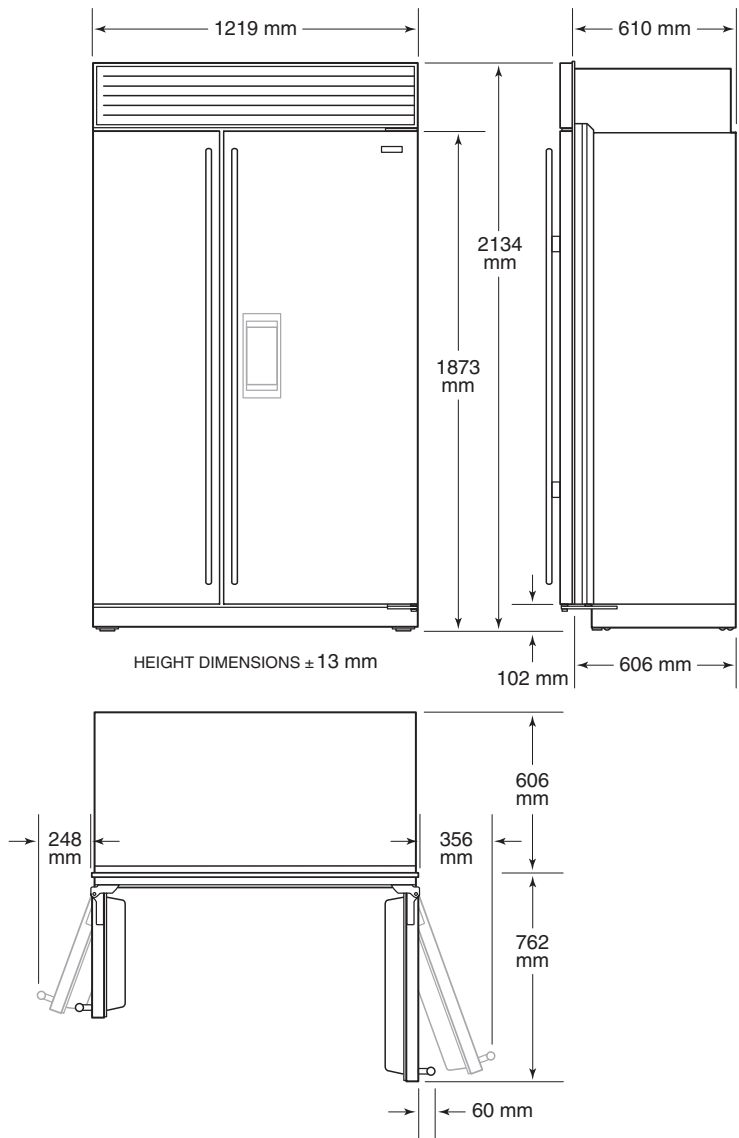

MODELS ICBBI-48S, ICBBI-48SD & ICBBI-48SID

Planning Information

ELECTRICAL REQUIREMENTS

International models from the factory designed without a transformer require a 220-240 V AC, 50/60 Hz electrical supply, fused at the correct rating for the unit. If required by local or national codes, the power cord can be easily replaced using the power inlet device.

Built-in models should have the electrical supply either in the cabinet above the refrigerator a MINIMUM OF 2200MM ABOVE THE FLOOR or in the cabinet alongside. If freestanding then locate the power point as per the diagram below. A separate circuit servicing only this appliance is required. A ground fault circuit interrupter (GFCI) is not recommended and may cause interruption of operation.

PLUMBING REQUIREMENTS

For built-in models with an automatic ice maker, a pressure limiting valve and 5 meters of flexible 6mm pipe with fittings is included in the refrigerator carton. Connect the pressure limiting valve close to the water tap, CHECKING THE WATER FLOW IS IN THE RIGHT DIRECTION. Ensure water connection is 1/2" BSP male threaded outlet. Tape the 6mm water line to the wall and floor to ensure it isn't squashed when the refrigerator is pushed into the cavity. Locate the water tap either in the cabinet above a minimum of 2200mm from the floor, or in the cabinet alongside.

The water line must not interfere with installation of the anti-tip brackets.

IMPORTANT NOTE: A reverse osmosis system can be used provided there is constant water pressure of 2.1 bar to 6.9 bar supplied to the unit at all times.

Electrical Requirements	
Power Supply	220-240 V AC, 50/60 Hz
Circuit Breaker	10 amp
Receptacle	3-prong grounding-type

Plumbing Requirements	
Water Supply Line	6mm plastic line
Water Pressure	2.1–6.9 bar
Water line for Connection	5m

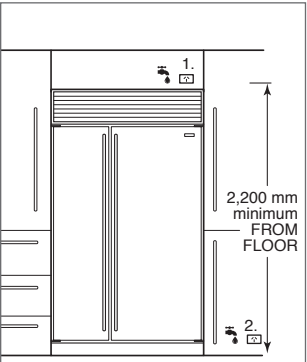

Built in. Alternative location of power & water supply depending on ease of access.

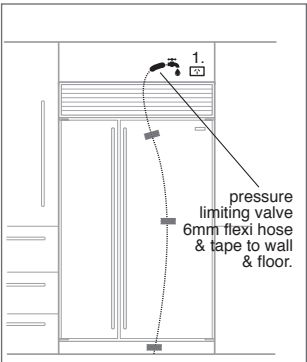

1. Built in. Water supply above fridge. Location of 6mm flexible hose. Tape to wall and floor with pressure limiting valve next to tap.

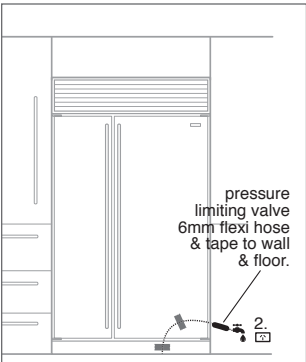

2. Built in. Water supply beside fridge. Location of 6mm flexible hose. Tape to wall and floor with pressure limiting valve next to tap.

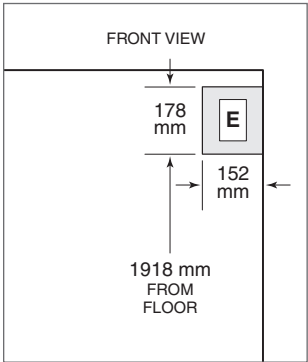

Freestanding location of power supply.

Stainless Flush Inset Application

It is necessary to consider the following points when planning for a flush inset application:

- The flush inset depth is 56 mm deeper than the standard opening depth.
- The flush inset width is 46 mm wider than the standard opening width.
- The flush inset height is 22 mm higher than the standard opening height.
- You must allow a 15 mm reveal around the perimeter of the unit and grille to allow for proper door swing and airflow.

IMPORTANT NOTE: The flush inset application is not a separate model. The same model is used in a standard or flush inset application of stainless steel fridge.

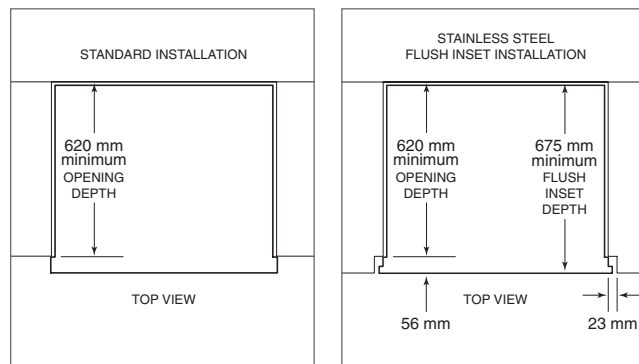

Standard installation.

Flush inset installation.



Built-In Models

FLUSH INSET INSTALLATION

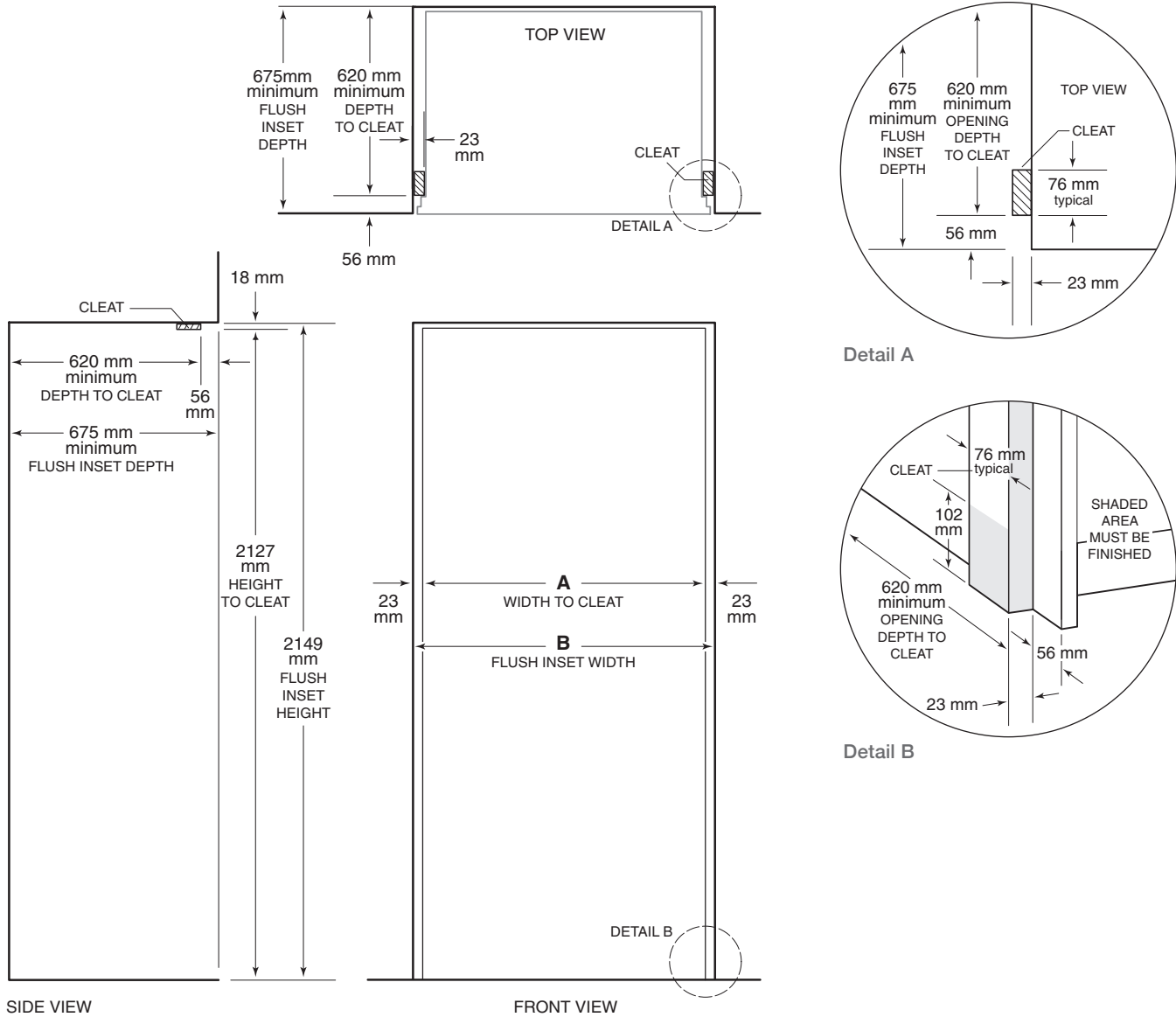

Flush Inset Opening Widths	A	B
ICBBW-30	749 mm	795 mm
ICBBI-36R, ICBBI-36F	902 mm	948 mm
ICBBI-36UID, ICBBI-36UFDID, ICBBI-36S	902 mm	948 mm
ICBBI-42UFDID, ICBBI-42S, ICBBI-42SD	1054 mm	1100 mm
ICBBI-48S, ICBBI-48SID, ICBBI-48SD	1206 mm	1252 mm

Dual Installation

STAINLESS FLUSH INSET APPLICATION

Installing two built-in models side by side in a stainless flush inset application will require adjustments to the dimensions of your finished rough opening. It will also require a dual installation kit, available through your authorized Sub-Zero dealer.

* Dual installations without a filler strip can only be accomplished using two units with opposite hinges as shown in illustration A below. The dual installations shown in illustrations B and C require a filler strip. Illustration A is the only application that will accommodate the dual wide grille.

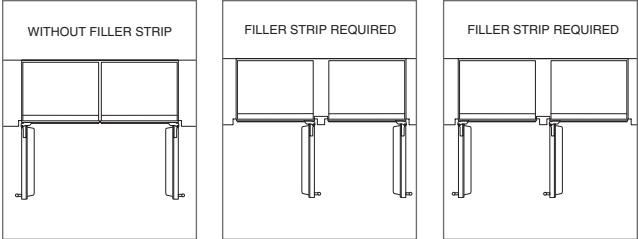

Illus. A

Illus. B

Illus. C



Dual Installation

STAINLESS FLUSH INSET INSTALLATION

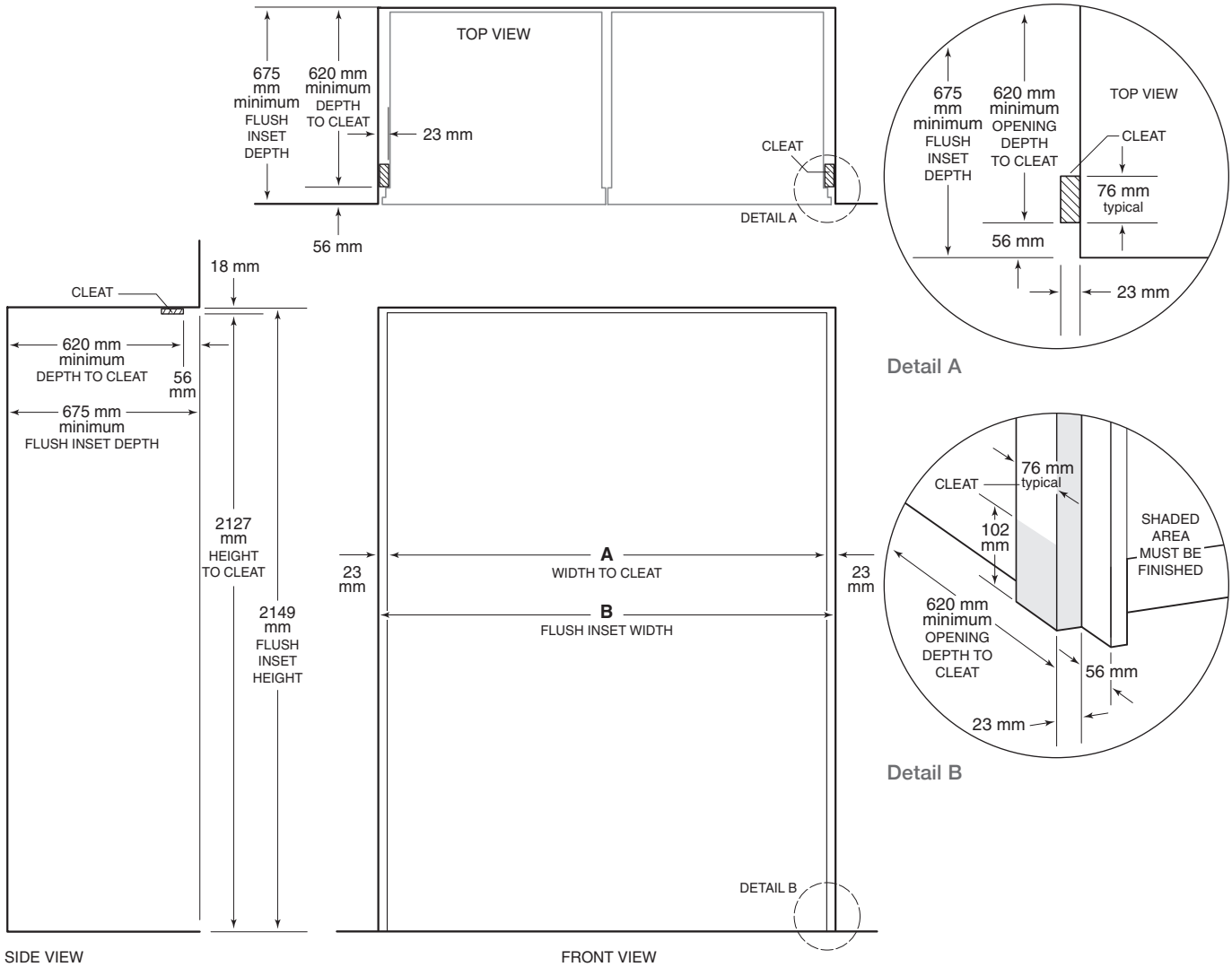

Opening Widths	A	B
Two 762 mm Models	1518 mm	1564 mm
762 mm and 914 mm Models	1670 mm	1716 mm
Two 914 mm Models	1822 mm	1868 mm

Sub-Zero International Limited Warranty

FOR RESIDENTIAL USE

FULL TWO YEAR WARRANTY*

For two years from the date of original installation, this Sub-Zero product warranty covers all parts and labor to repair or replace, under normal residential use, any part of the product that proves to be defective in materials or workmanship. All service provided by Sub-Zero under the above warranty must be performed by Sub-Zero factory certified service, unless otherwise specified by Sub-Zero, Inc. Service will be provided during normal business hours.

FULL FIVE YEAR SEALED SYSTEM WARRANTY

For five years from the date of original installation, this Sub-Zero product warranty covers all parts and labor to repair or replace, under normal residential use, these parts that prove to be defective in materials or workmanship: compressor, condenser, evaporator, drier and all connecting tubing. All service provided by Sub-Zero under the above warranty must be performed by Sub-Zero factory certified service, unless otherwise specified by Sub-Zero, Inc. Service will be provided during normal business hours.

For more information regarding your Sub-Zero product warranty, contact your authorized Sub-Zero dealer. Warranties must comply to all country, state, city, local and or ordinance.

*Stainless steel (doors, panels, handles, product frames and interior surfaces) are covered by a limited 60-day parts and labor warranty for cosmetic defects.

*Replacement water filters and air purification cartridges are not covered by the product warranty.





SUB-ZERO GROUP AUSTRALIA PTY LTD

Bank House, 11 – 19 Bank Place.
Melbourne Victoria Australia 3000
Telephone 03 9600 2218

enquiries@subzero.com



SUBZERO-WOLF.COM.AU